

# Welcome to Leipzig!

Your conference &  
congress destination



# How to get there

## Leipzig/Halle Airport

- 18 km from Leipzig and 23 km from Halle
- regular flights to and from Frankfurt am Main
- direct international flights to and from Vienna and Istanbul
- the tram takes you to the city centre in 12 mins, or to Leipzig's "Messegelände" (trade fair grounds) in 6 mins





# How to get there

## Leipzig Central Station

- via ICE, IC, EC, IR
- Europe's largest terminus station
- Promenaden Hauptbahnhof (Central Station Mall) offers over 140 shops
- 14 min (1.0 km) walking distance to Leipzig market square



## Motorways

- A9 (Berlin – München)
- A14 (Dresden – Halle)
- A38 (Göttingen – Leipzig)





[click here for the video](#)

# LEIPZIG

lautsprache  
['laɪpt͡sɪç]

~~irgendwo im Osten, Stadt im Freistaat~~  
Sachsen, historisches Zentrum der Wirtschaft

~~Sachsen, die Sachsen betreffend, von den Sachsen stammend~~  
zu ihnen gehörend



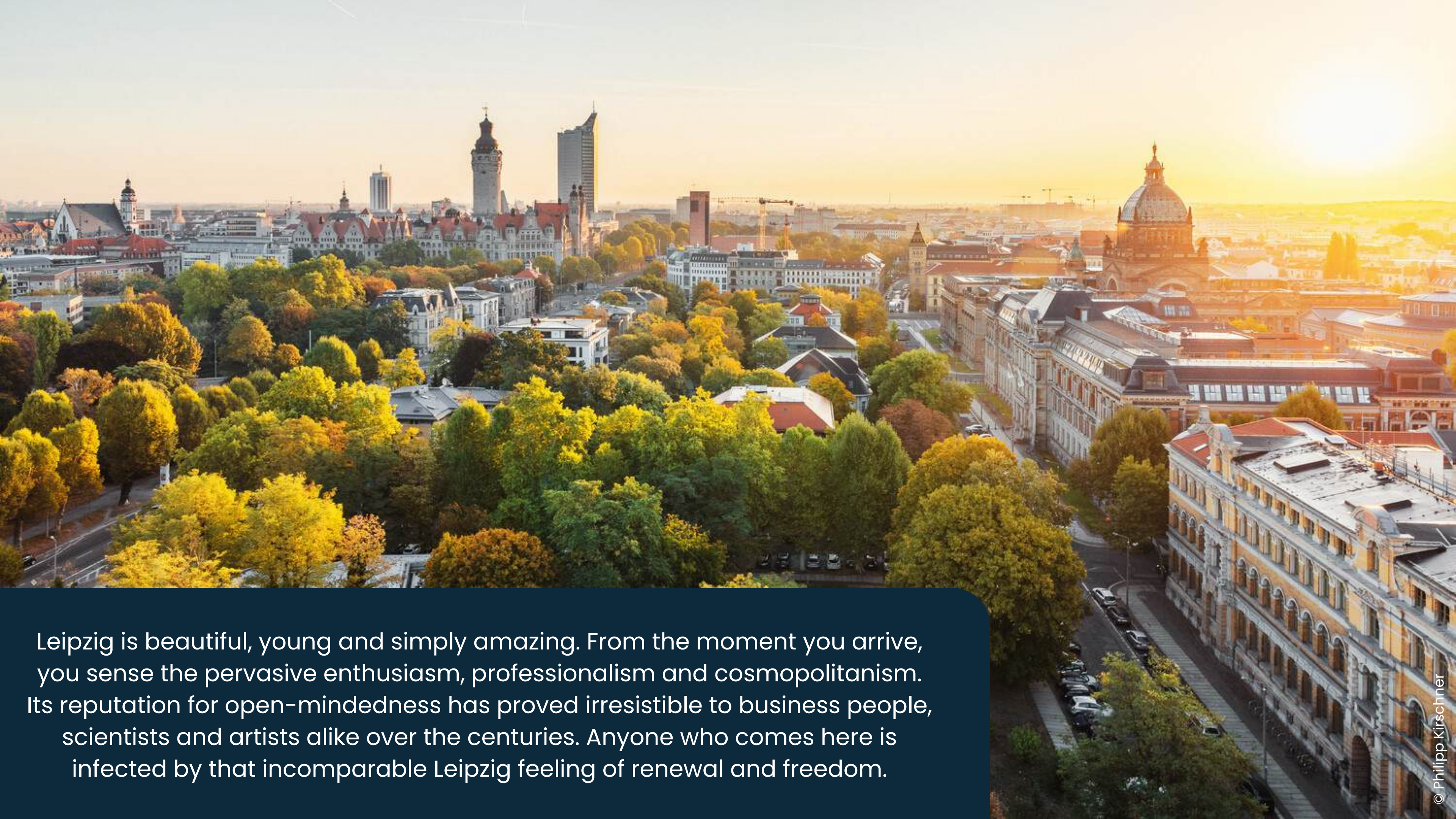

Leipzig is beautiful, young and simply amazing. From the moment you arrive, you sense the pervasive enthusiasm, professionalism and cosmopolitanism. Its reputation for open-mindedness has proved irresistible to business people, scientists and artists alike over the centuries. Anyone who comes here is infected by that incomparable Leipzig feeling of renewal and freedom.





Augustusplatz square with Leipzig Gewandhaus concert hall and City High-rise with Panorama Tower restaurant





Monument to the Battle of the Nations and FORUM 1813 – Museum





Buntgarnwerke on the shore of the White Elster River



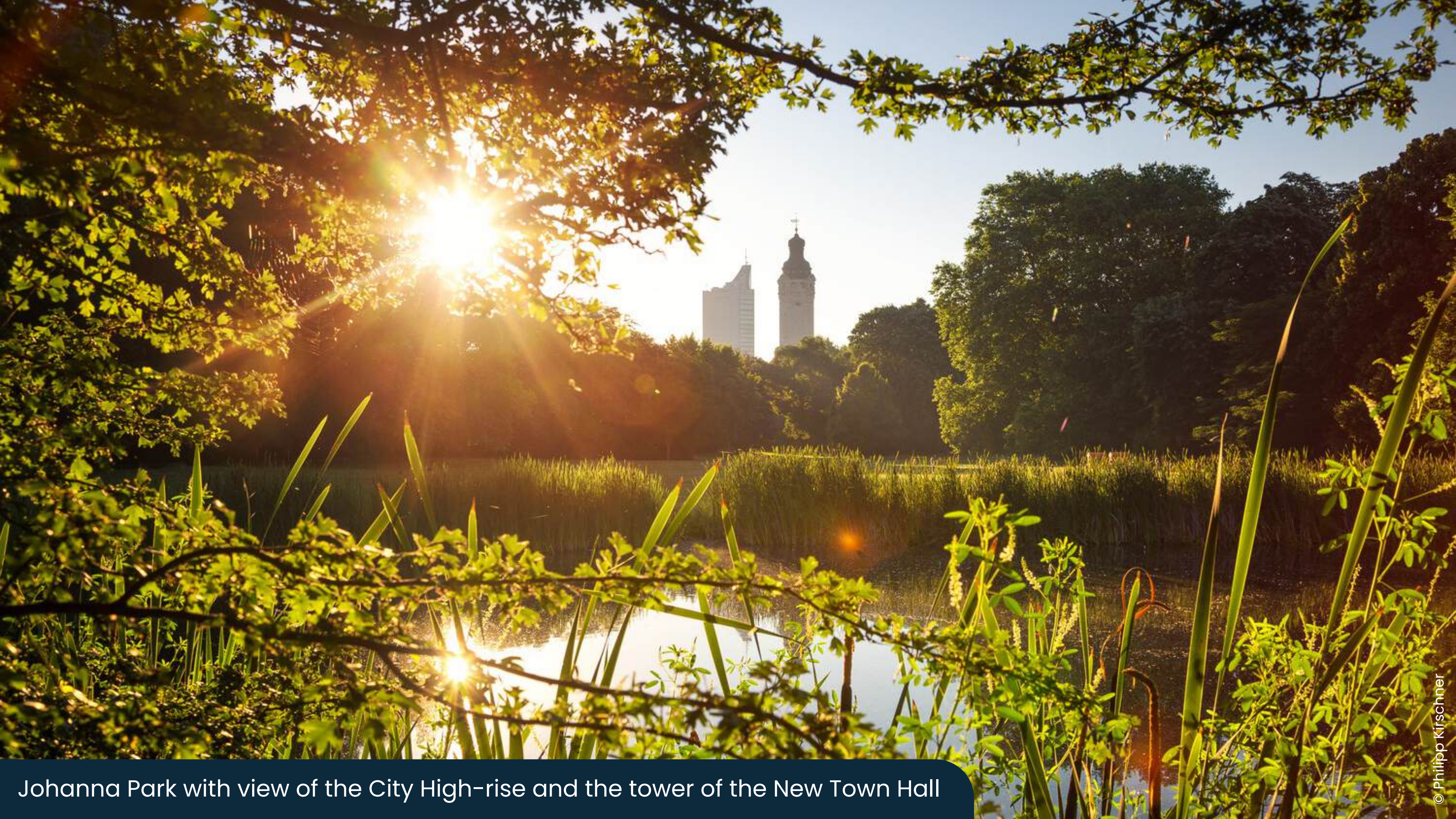

Johanna Park with view of the City High-rise and the tower of the New Town Hall



# Leipzig – City of Music

- Johann Sebastian Bach, Felix Mendelssohn Bartholdy, Robert Schumann and Richard Wagner lived and worked in Leipzig
- music ambassadors today: Leipzig Gewandhaus Orchestra, St. Thomas' Boys Choir
- annual festivals: Leipzig Bachfest, Mendelssohn Festival, Opera Festival





# Leipzig – City of European History

- city of the 1989 Peaceful Revolution
- decisive Monday Demonstration in Leipzig (70,000 people) led to the fall of the Berlin Wall on Nov. 9th, 1989
- authentic places: St. Nicolas Church, Museum in the Round Corner, etc.





# Leipzigs Innovation clusters and focus industries

## Life Sciences



- German Centre for Integrative Biodiversity Research (iDiv)
- Fraunhofer Institute for Cell Therapy and Immunology IZI
- BIO CITY LEIPZIG
- University of Leipzig
- Max Planck Institutes



## Digital economy



- Cloud Computing
- Games & XR-Technologies
- Artificial intelligence
- IT-Security
- Industry software

## GreenTech



- German Biomass Research Center gGmbH
- Helmholtz Center for Environmental Research
- Leipzig University of Applied Sciences (HTWK)
- Leipzig University
- L-Group
- EEX
- VNG



# Industry competences in Leipzig

## Automotive



with Porsche Leipzig GmbH, BMW plant and suppliers

## Tourism



Important MICE location, rich history, art and culture, diverse sights

## Logistics



with DHL hub, Amazon, Aerologic, Beiersdorf, Momox SE, Future Electronics, Tri5G project network

## Media & creative industries

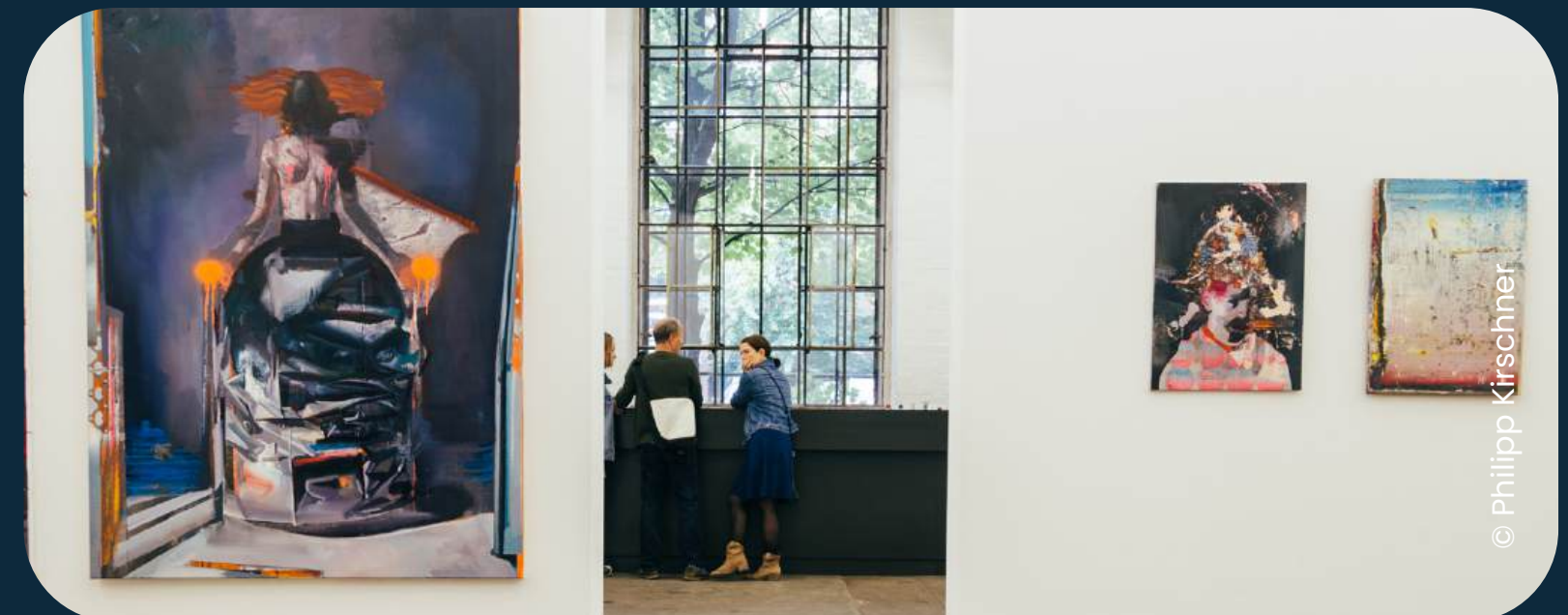

with MDR in the ARD network, industry get-togethers such as the book fair and Dok-Filmwoche, lively start-up scene



# Leipzig Convention Network



The Leipzig Convention Network (LCN) is a network of around 50 partners, including congress and event venues, conference hotels, service agencies, local PCOs and mobility partners.

We work together to promote Leipzig as a place to meet, supporting event planners and cooperating closely on the planning, organisation and implementation of events of all formats and sizes.



# www.leipzig-convention.com

Conference hotels

Website with search  
functions

Event venues

360 degree Virtual Site  
Inspection

Leipzig brochures

Social programmes,  
excursions and tours

Service agencies and  
local PCOs

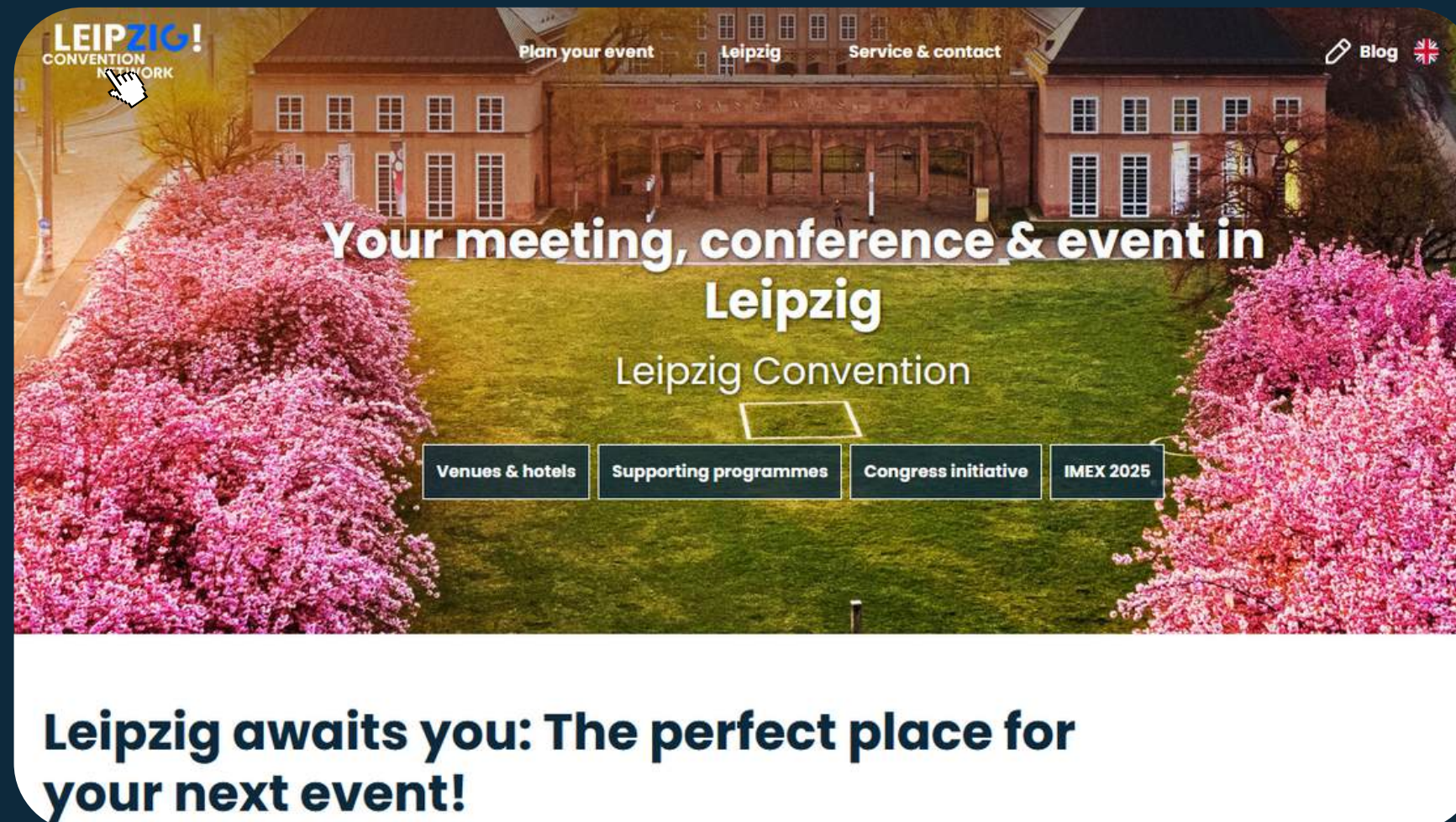

Detailed supplier  
information

Leipzig Convention News

Professional advice

Direct contact to  
suppliers

Mobility partners



# Leipzig – vibrant congress city

## Congress Center Leipzig (CCL)

- Leipzig's largest convention facility with 23 conference rooms and halls
- perfect place for every business or professional gathering
- CCL in conjunction with hall 2 – purpose-built auditoria for up to 10,000 people
- Green Globe Certificate since 2010

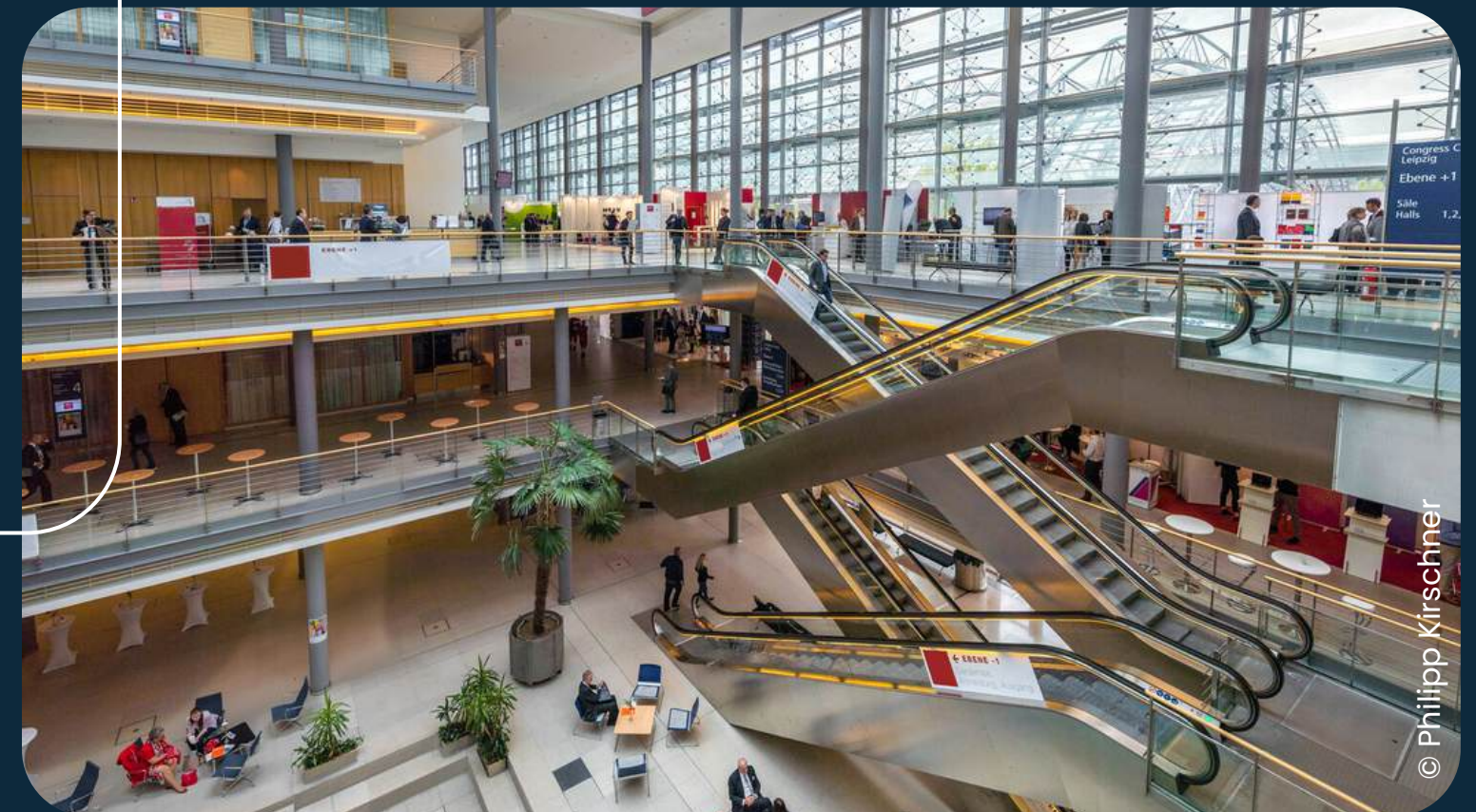
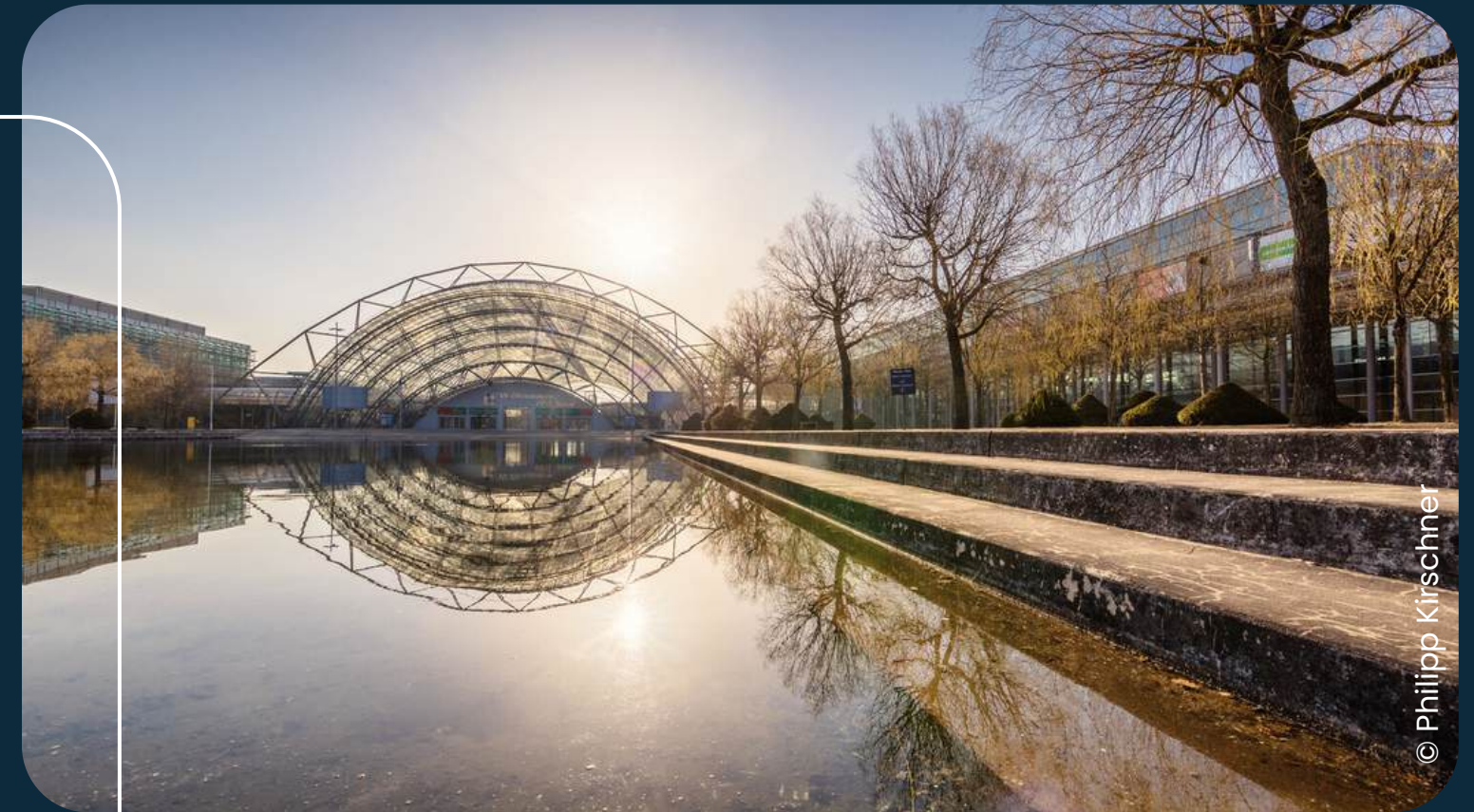



# Leipzig – vibrant congress city

## KONGRESSHALLE am Zoo Leipzig

- inaugurated in 1900 as an important venue for civic celebrations and associations
- today: operated by CCL Congress Center Leipzig
- features 15 halls and rooms for 10 to 1,200 people, numerous foyers, lounges and an area for exhibitions for flexible and creative space concepts
- centrally located near hotels, restaurants and numerous cultural attractions





# Event venue: Porsche Experience Centre Leipzig

- indoor area with 5,000 m<sup>2</sup> for over 680 guests in the Customer Centre with Porsche Auditorium
- 8 conference rooms
- outdoor area: 400 hectares
- extraordinary supporting programmes with factory tour and driving event on FIA-certified Porsche circuit





# Event venue: Red Bull Arena Leipzig

- event space Stadium View with 1,072 m<sup>2</sup> for 478 guests
- 13 conference rooms
- comfortably equipped, sophisticated and high-quality premises in a unique atmosphere
- professional employees will assist with organization and detailed arrangements as well as support on the day of the event





# Zoo Leipzig GmbH

- ape world Pongoland, which is unique of its kind in the world
- Gondwanaland with the size of two football pitches, where you can see tropical rain forest right in the middle of Leipzig
- 8 event locations
- catering by Marché Mövenpick Deutschland GmbH and Sodexo Services GmbH
- supporting programmes



© Zoo Leipzig

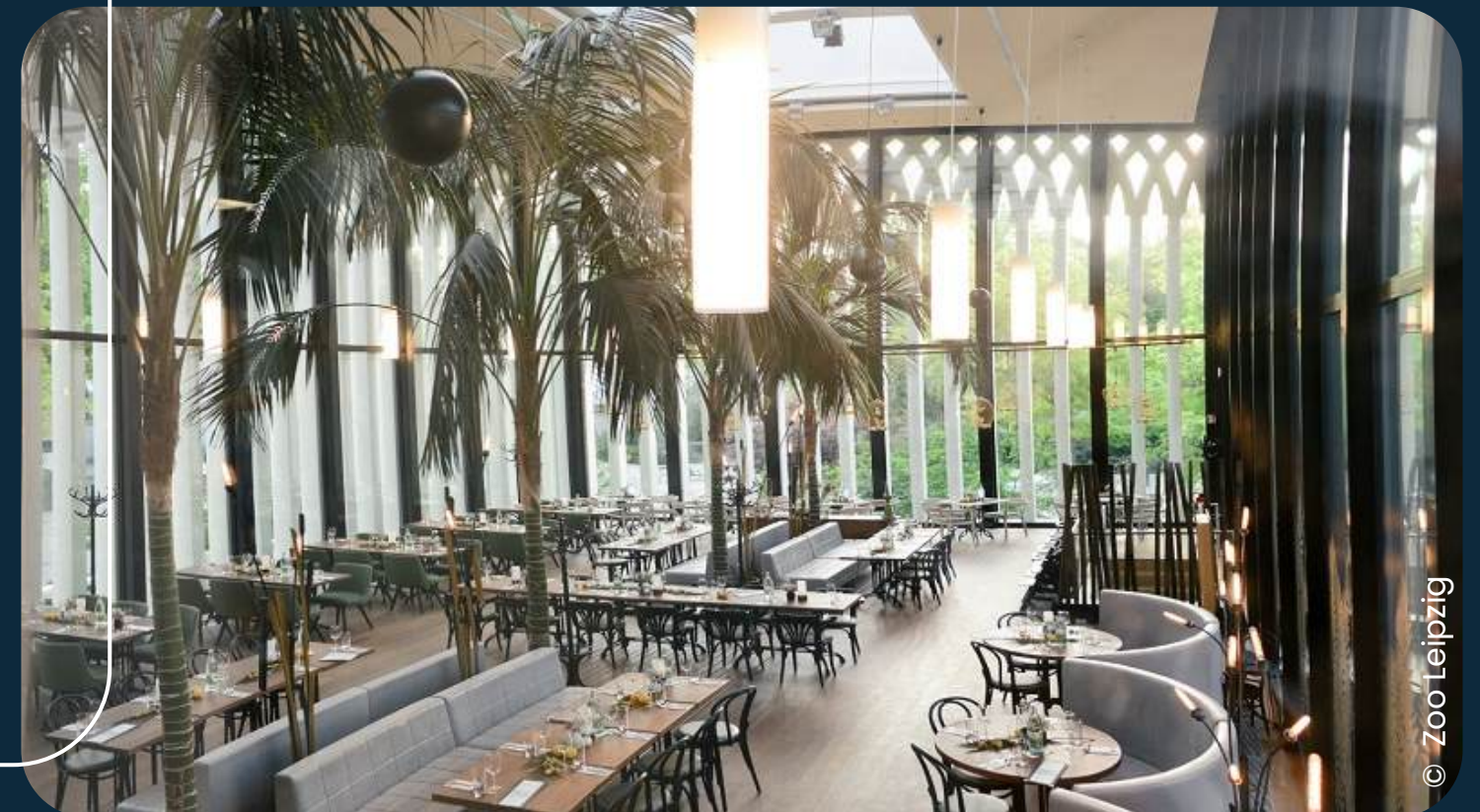

© Zoo Leipzig



# Event venues – historic, modern, exclusive



Da Capo Oldtimermuseum  
& Eventhalle



Kunstkraftwerk



Staycity Aparthotels  
Leipzig City Centre



Moritzbastei



Salles de Pologne



media city



# Hotel capacity

- almost 22,000 guest beds and nearly 9,500 hotel rooms
- more than 40% in 4\* or 5\*-hotels
- well-known brands like Marriott, Accor, Steigenberger, Westin, Radisson Blu
- meeting and convention rooms in hotels for up to 1,000 people





# Incentives and supporting programs

- Porsche Driving Experience Pilot & Co-Pilot
- boat and canoe tours on Leipzig's waterways
- whitewater rafting tour
- city rally with sight-seeing tour
- pub districts and nightlife





[click here for the video](#)



# THE ANSWER IS LEIPZIG



See you  
in Leipzig!

**Leipzig Convention Bureau**

Leipzig Tourismus und Marketing GmbH | Grimmaischer Steinweg 8 | 04103 Leipzig | Deutschland

**[www.leipzig-convention.com/en](http://www.leipzig-convention.com/en)**

+49 341 7104 242 | [kongress@ltm-leipzig.de](mailto:kongress@ltm-leipzig.de)